

LPAS



DeAnza
College

Services for Students

Agenda

Goals & Considerations
Master Plan Recap
Program Understanding
Preliminary Adjacency Concepts
Tasks and Next Steps

D1

Goals & Considerations



Project Goals:

- Improve Student Experience and Access to Services
- Improve Visibility and Wayfinding to Services
- Inclusive and Welcoming to Potential New and Existing Students
- Works with Other Service and Function Locations
- Serve the students through an equity lens

Project Considerations:

- Given that this building will be front and center on campus, what parts of its program should be the most prominent?
- Are all of the appropriate programs included in our current program understanding?
- Some of the existing programs on campus have inadequate space currently, according to their users – how much expansion of those programs can the project accommodate?
- What amount of expansion for programs that don't currently exist be planned for?

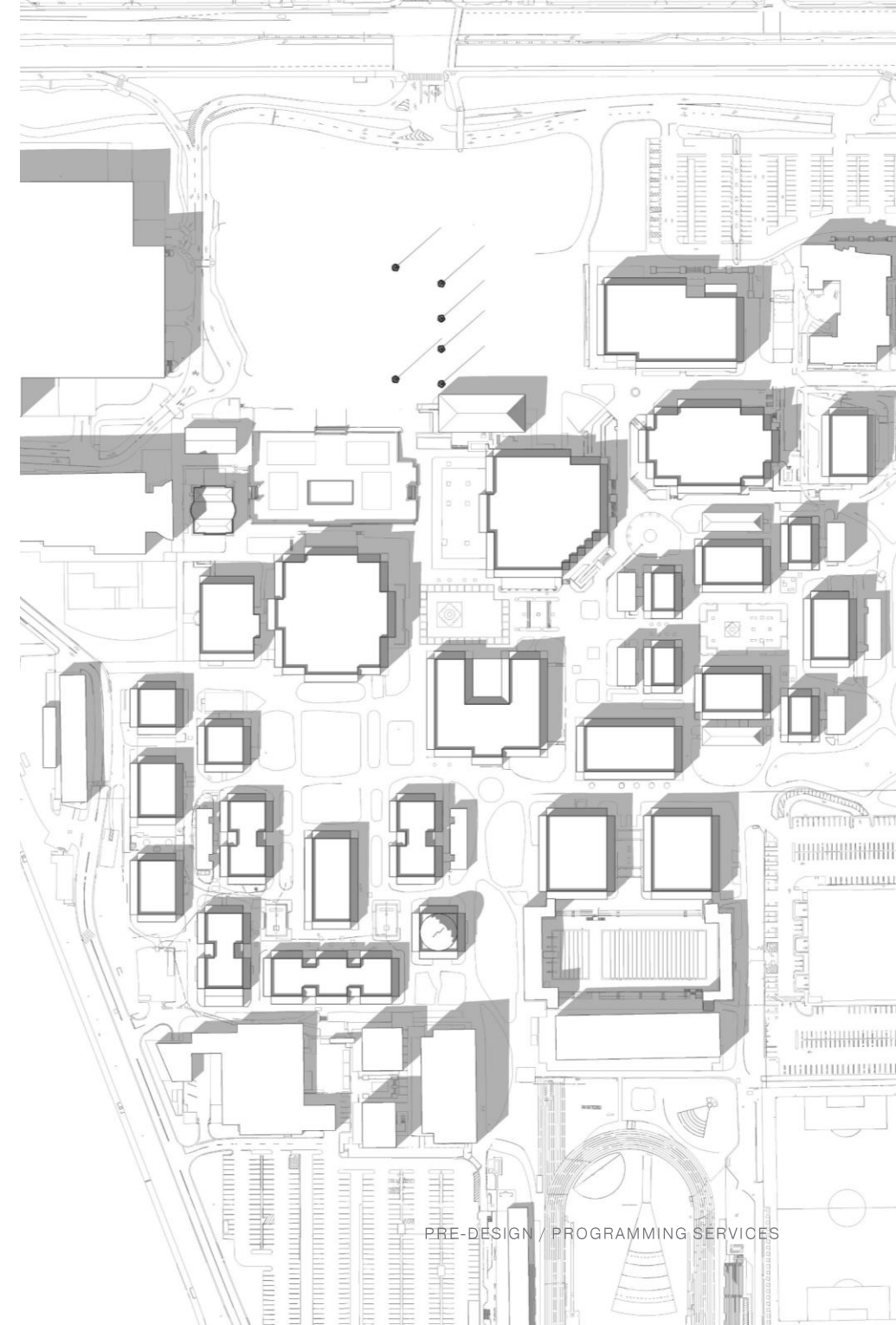

02

Master Plan Recap



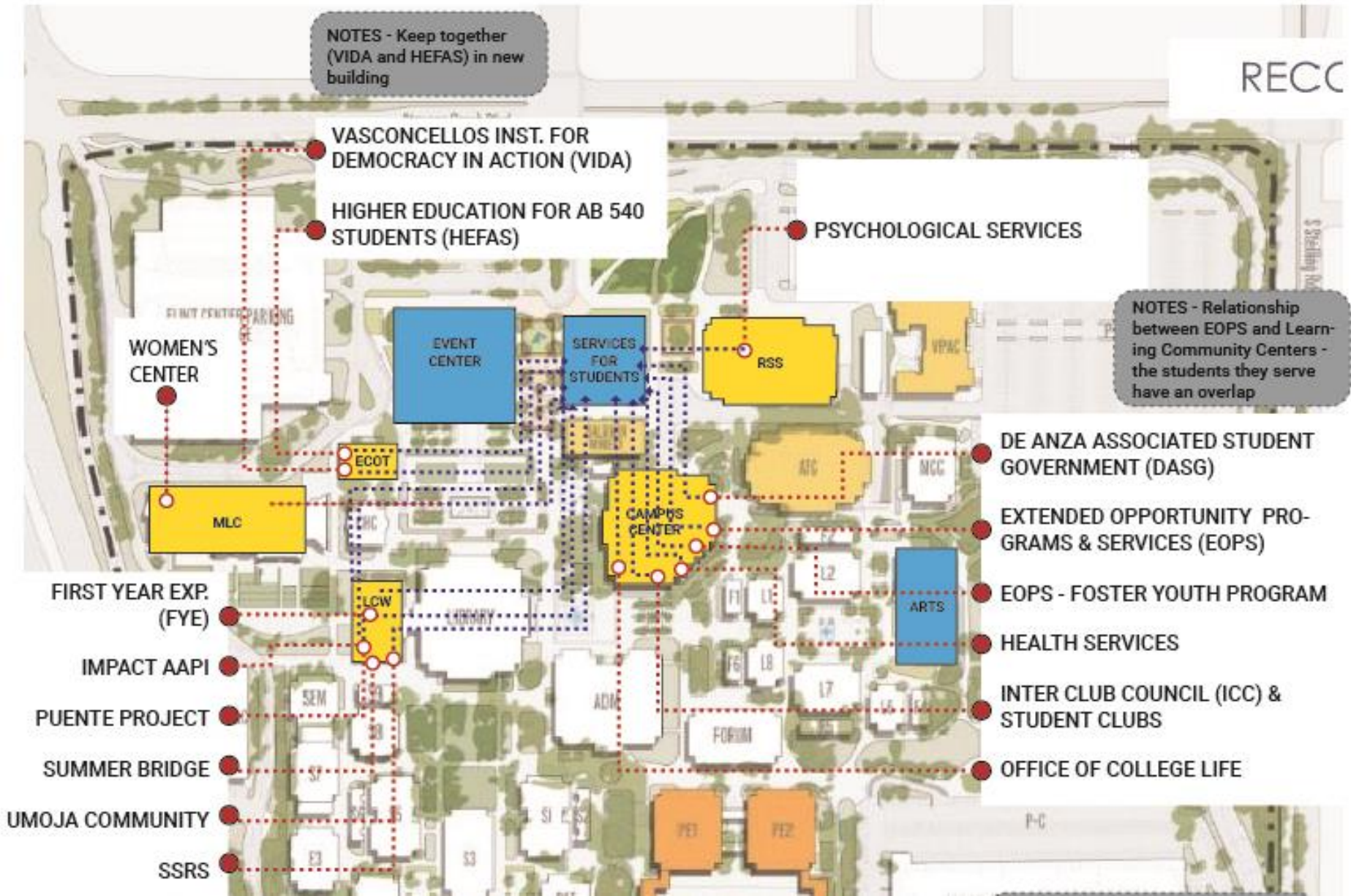

Updated Relocation Map
Services for Students Building

03

Program Understanding



Office of College Life & Student Accounts

3,020sf

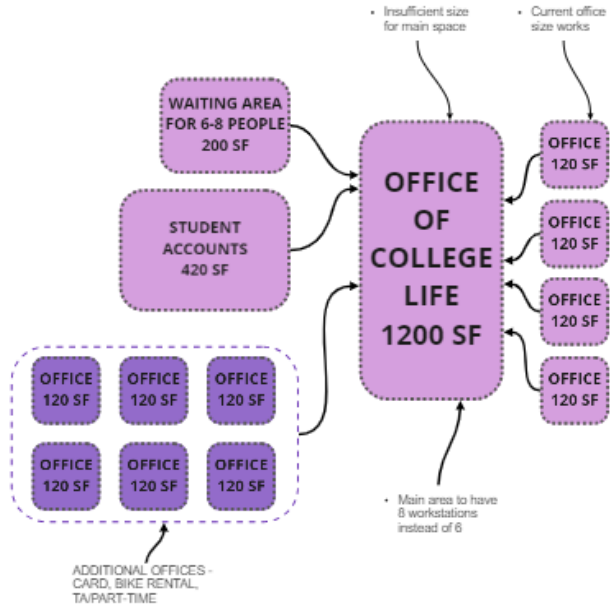

Health Services

3,000sf

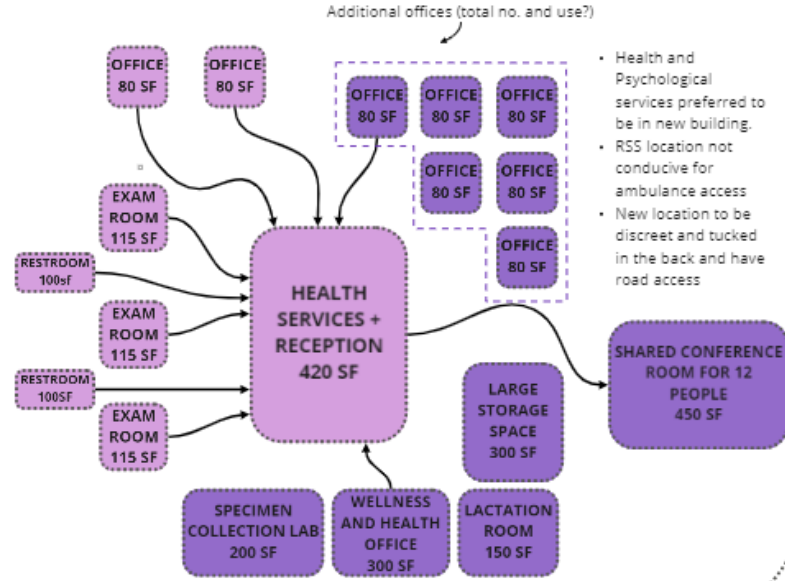

Psychological Services

1,400sf

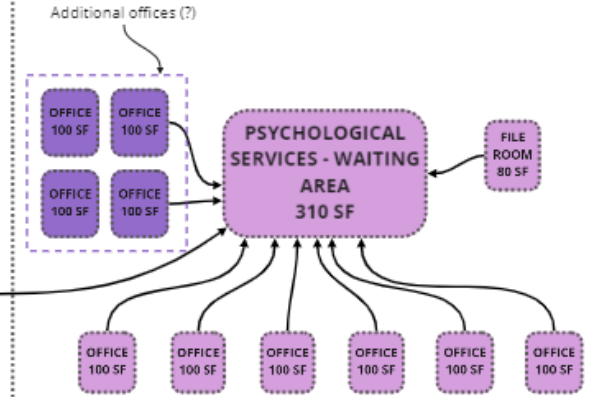

De Anza Student Government

3,820sf

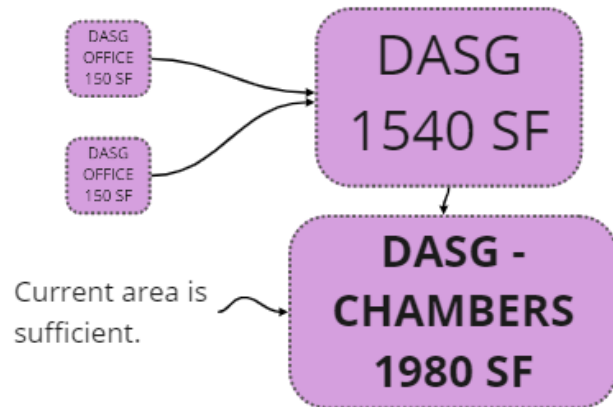

Inter Club Council

585sf

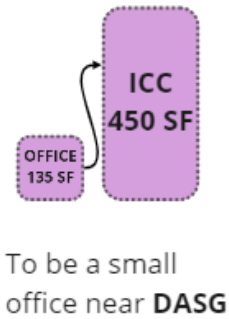

Extended Opportunity Programs & Services

2,990sf

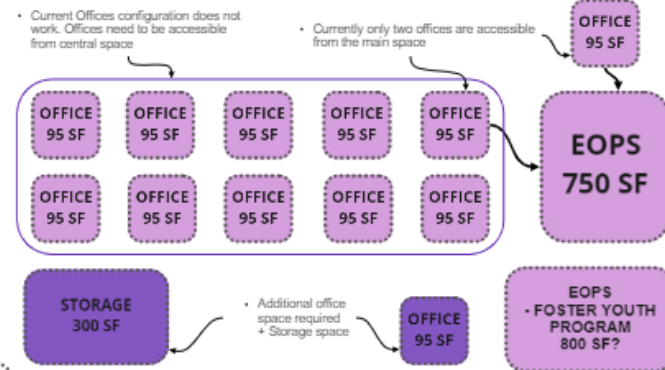

Future Programs

Size TBD



Health Services

3,000sf

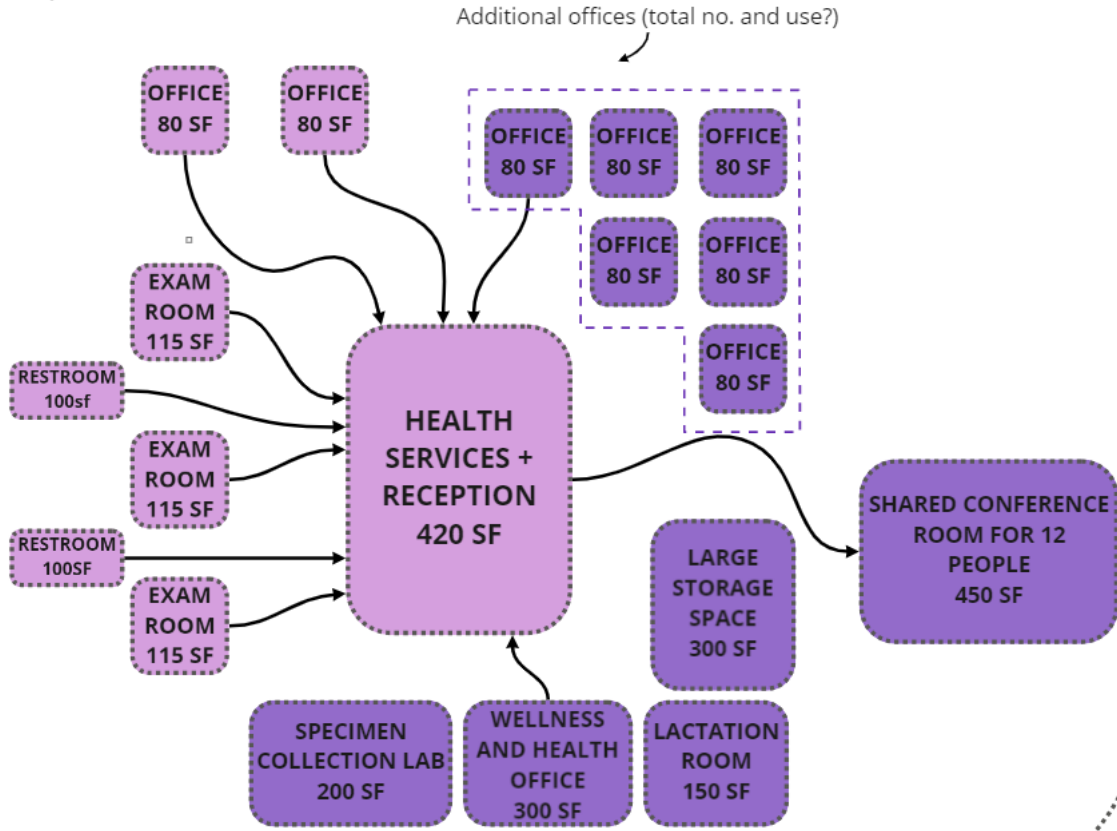

Existing Area: 1,100sf

Requested Additional Area*: 1,880sf

Total: 3,000sf

Psychological Services

1,400sf

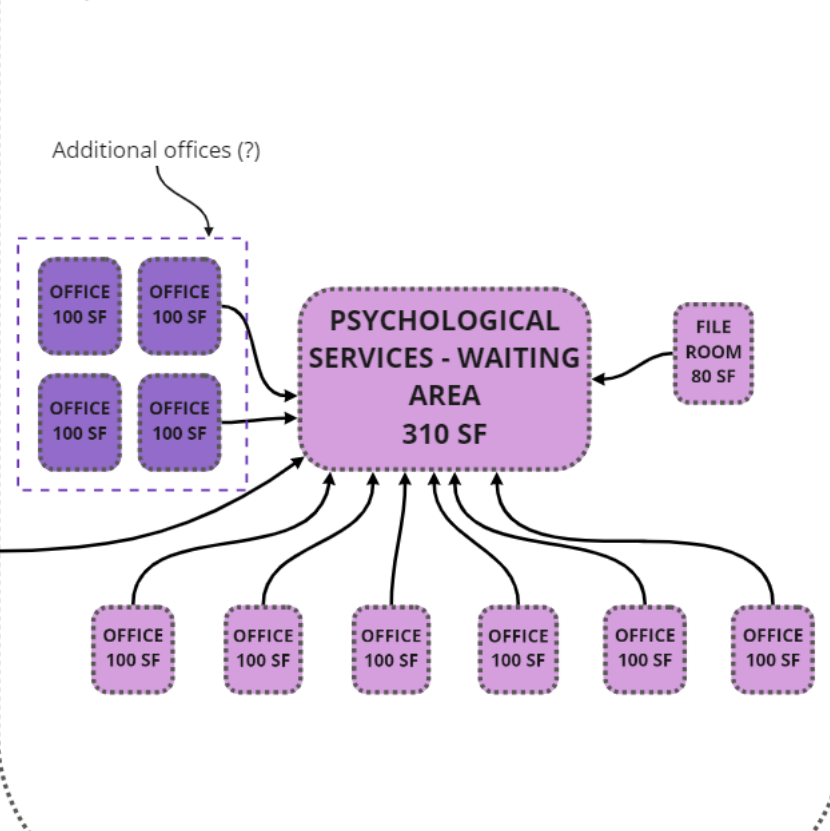

Existing Area: 1,000sf

Requested Additional Area*: 400sf

Total: 1,400sf

Extended Opportunity Programs & Services

2,990sf

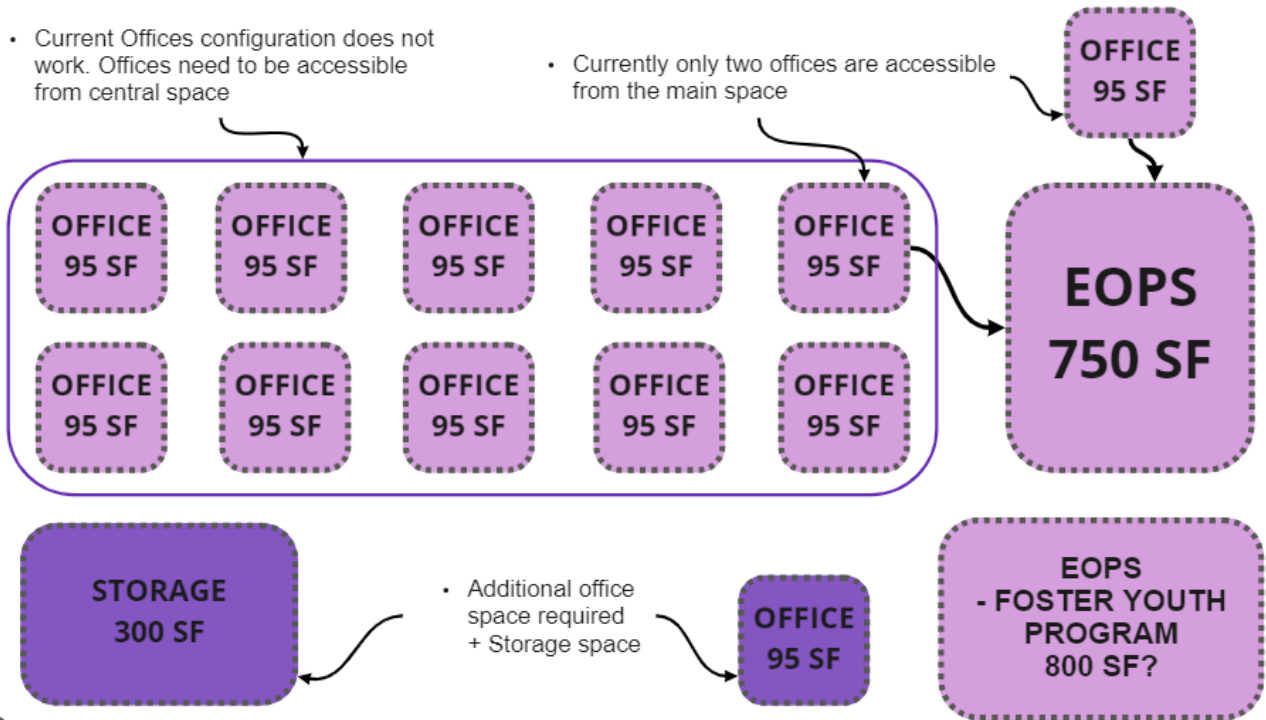

Existing Area: 2,595sf

Requested Additional Area*: 395sf

Total: 2,990sf

Office of College Life & Student Accounts

3,020sf

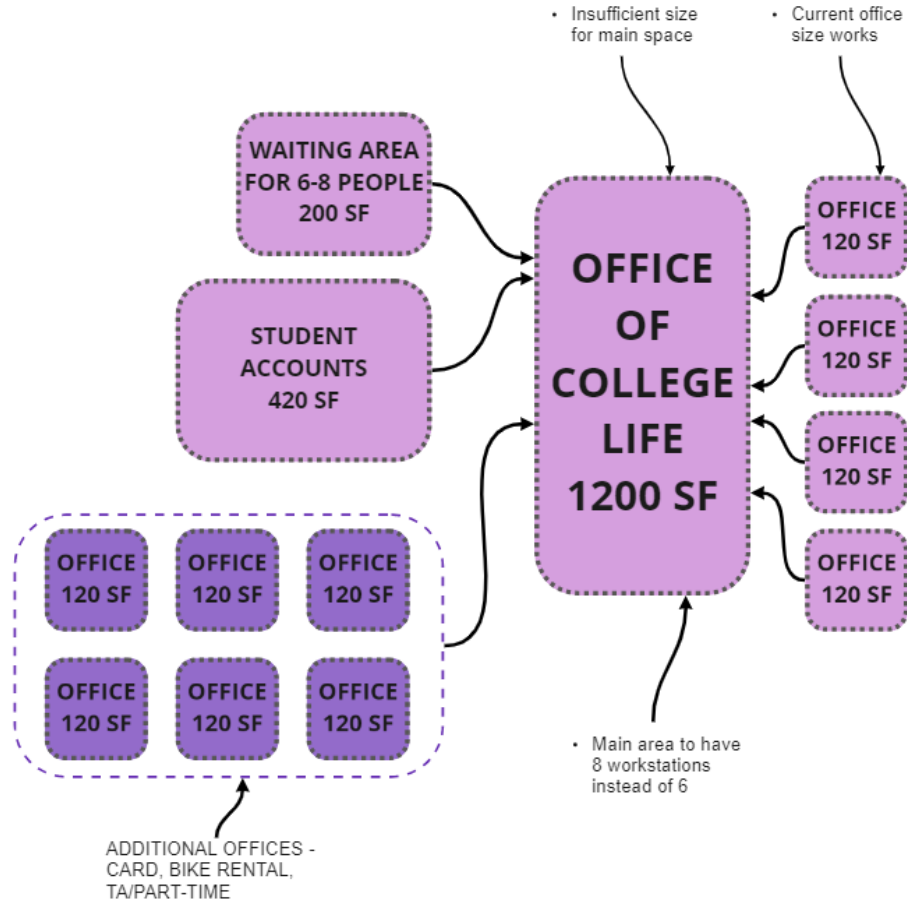

Existing Area: 2,300sf

Requested Additional Area*: 720sf

Total: 3,020sf

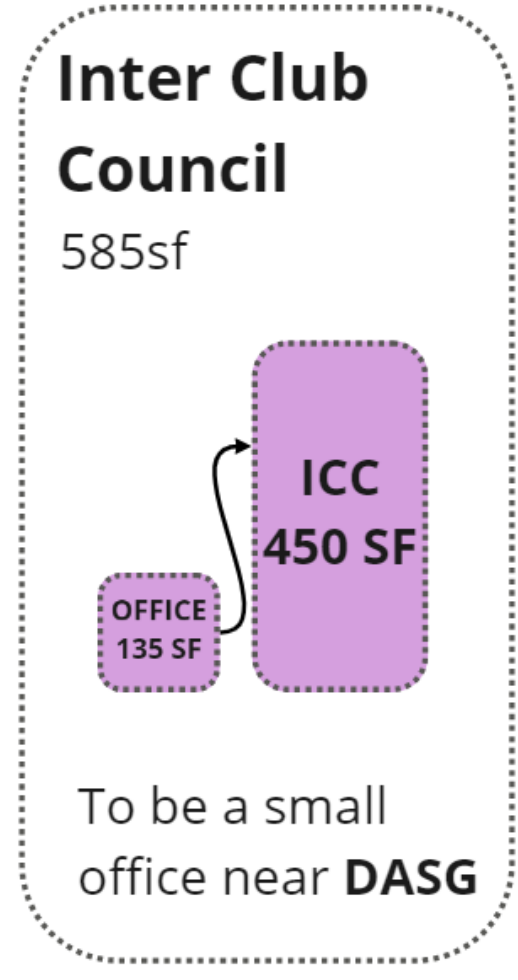
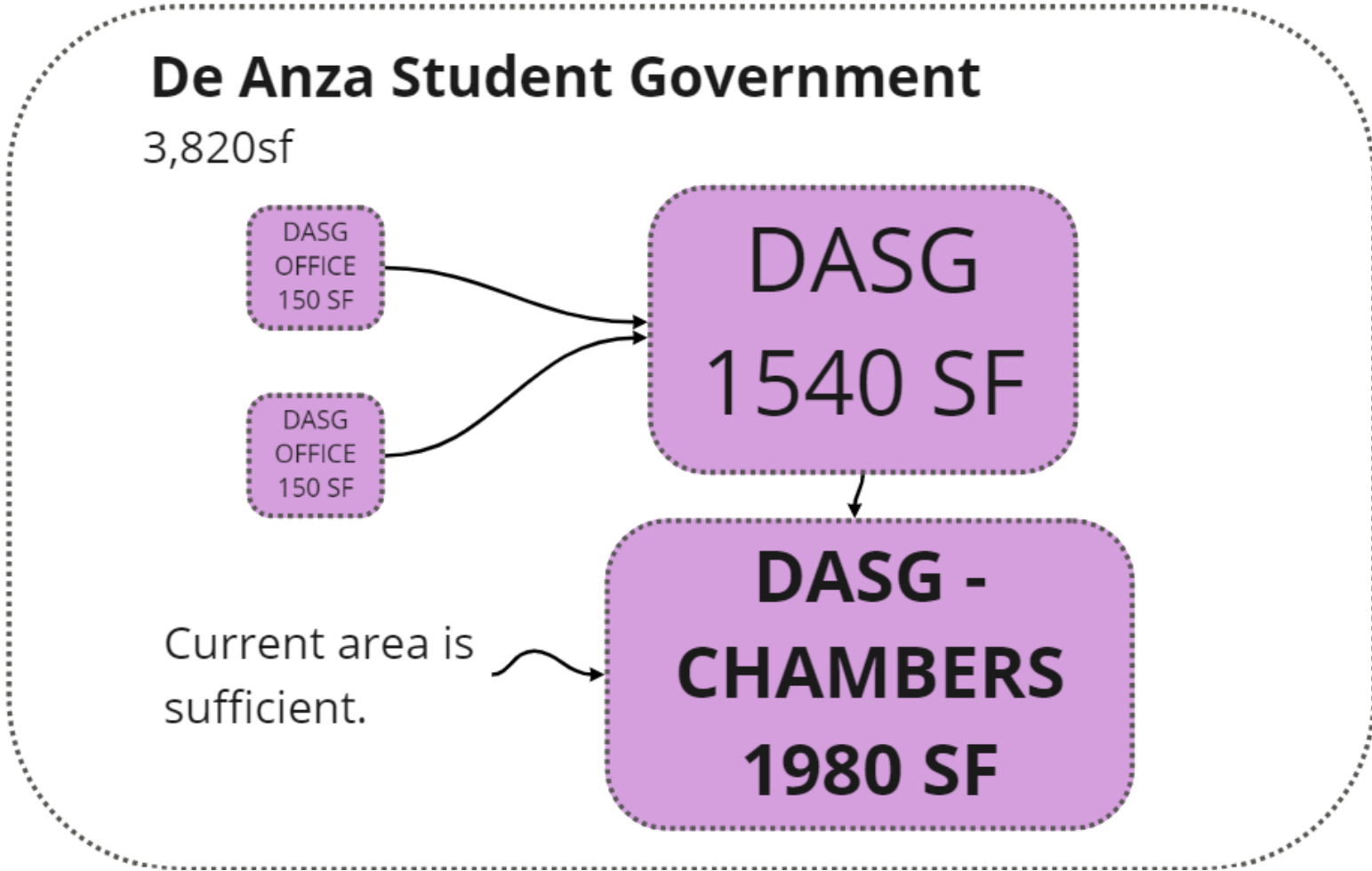

Existing Area: 3,820sf

Requested Additional Area: 0sf

Total: 3,820sf

Existing Area: 585sf

Requested Additional Area: 0sf

Total: 585sf

EPIC Center

4,100sf

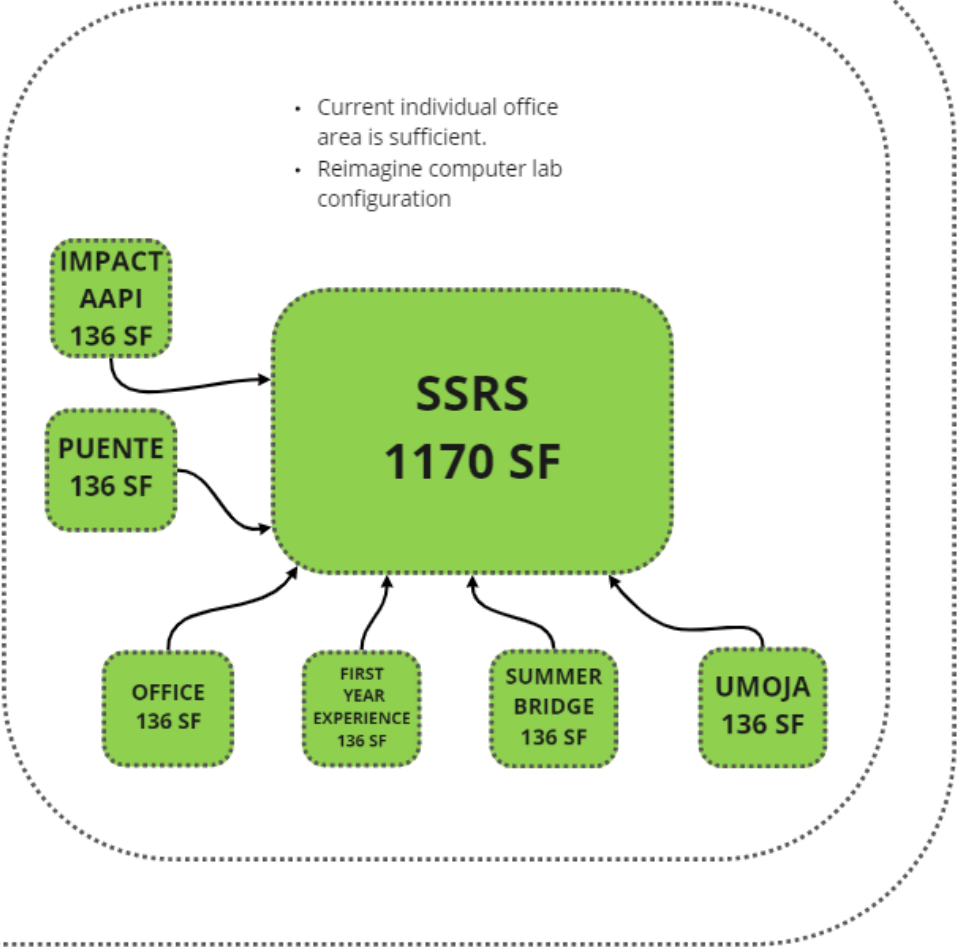
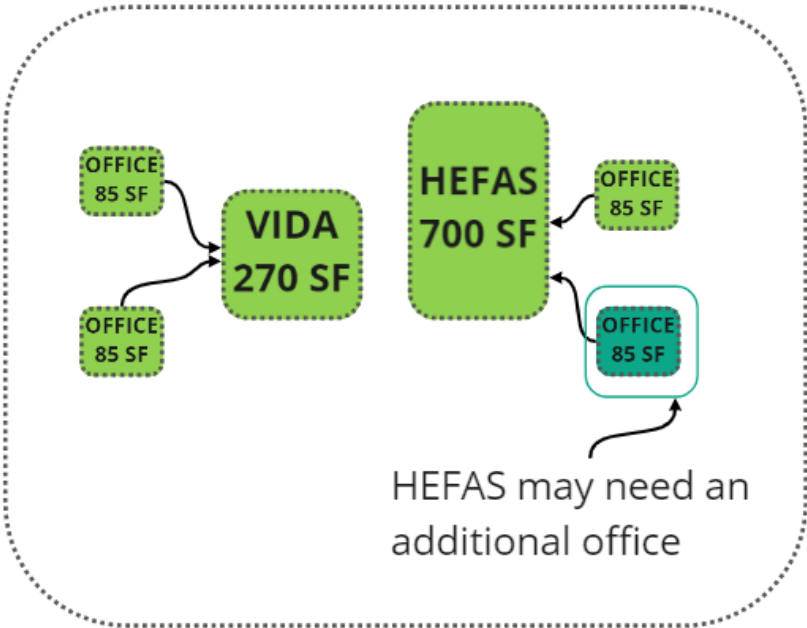

Existing Area: 4,015sf

Requested Additional Area*: 85sf

Total: 4,100sf

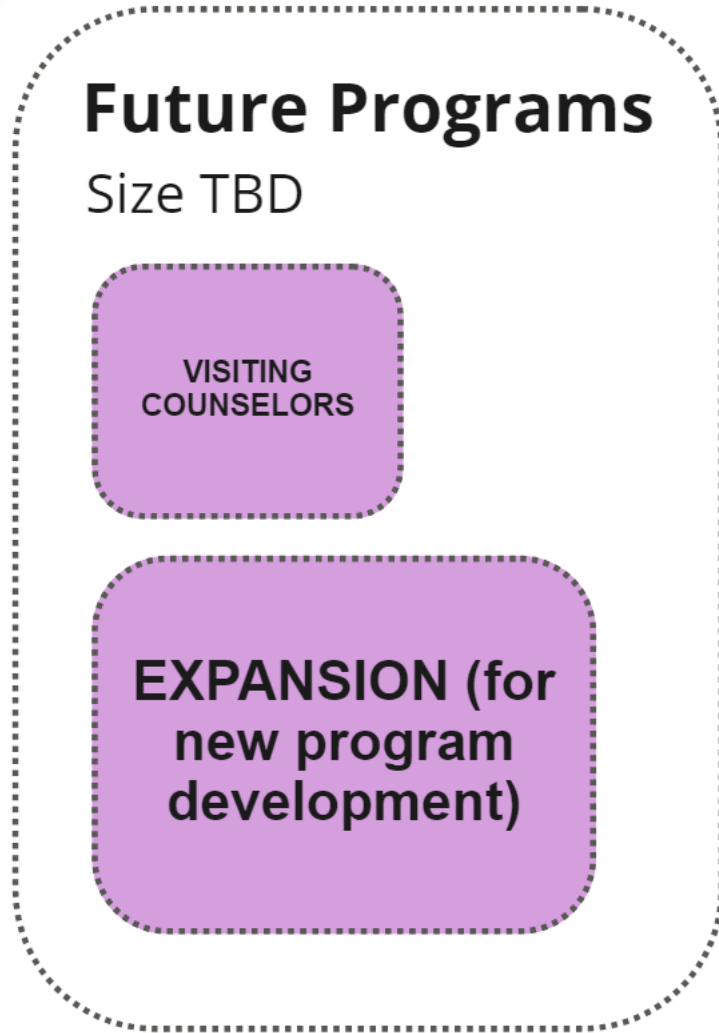

Existing Square Footage Only

Health Services	1,100sf
Psych Services	1,000sf
Office of College Life & Student Accts.	2,300sf
De Anza Student Government	3,820sf
Inter Club Council	585sf
EOPS	2,595sf
EPIC Center	4,015sf

Total ASF: 15,415sf
 +1.67 load factor
Total GSF: 25,740sf

Expanded Square Footage

LP/S

Health Services	3,000sf
Psych Services	1,400sf
Office of College Life & Student Accts.	3,020sf
De Anza Student Government	3,820sf
Inter Club Council	585sf
EOPS	2,990sf
EPIC Center	4,100sf
Future Expansion	TBD

Total: 18,330sf
 +1.67 load factor
Total GSF: 30,600sf

Program Summary & Preliminary Building Size Students for Services Building

04

Preliminary Adjacency Concepts



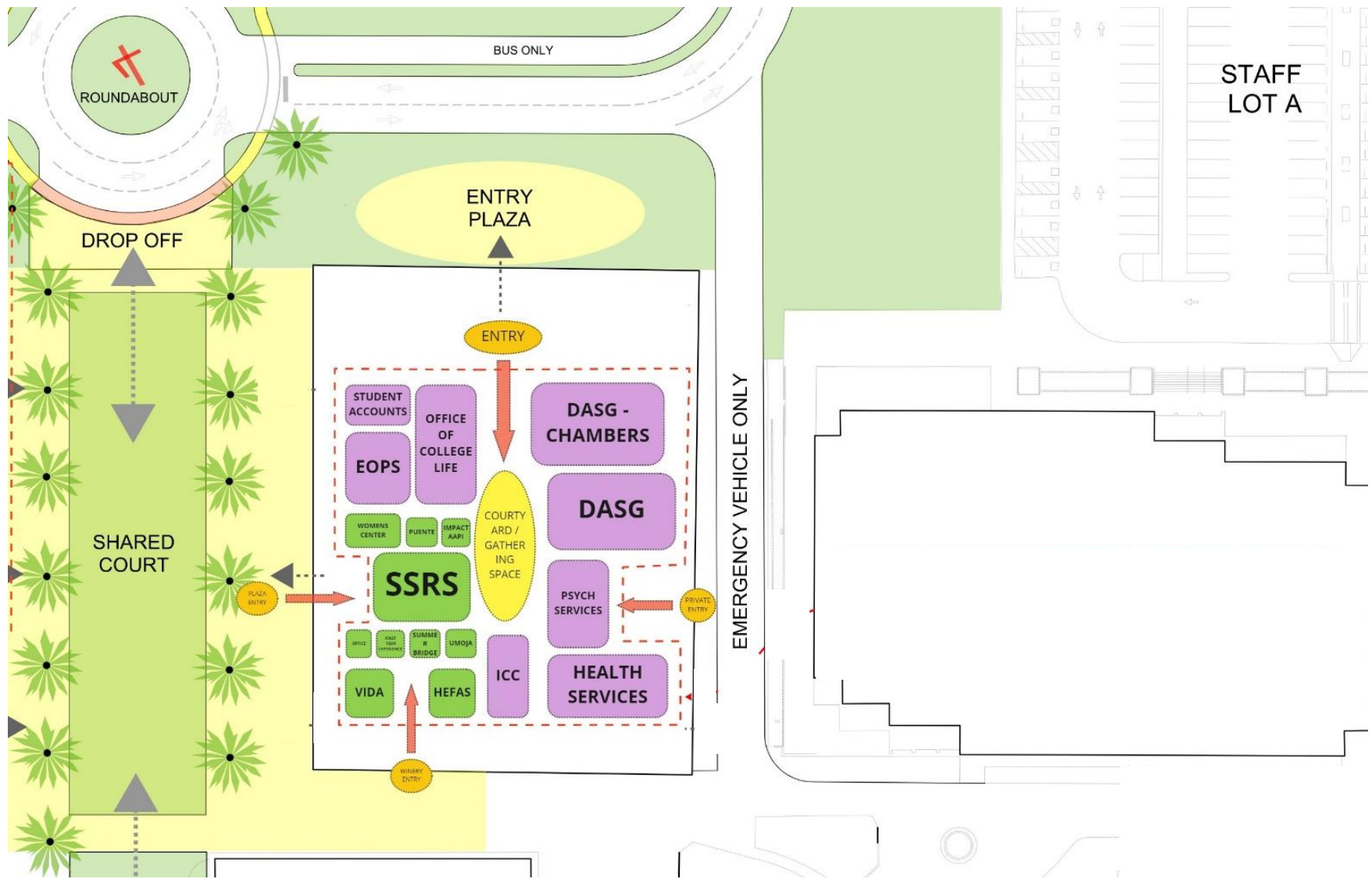

Adjacency Diagram - 1-Story Building
Option A



Adjacency Diagram - 2-Story Building
Option B

05

Tasks and Next Steps

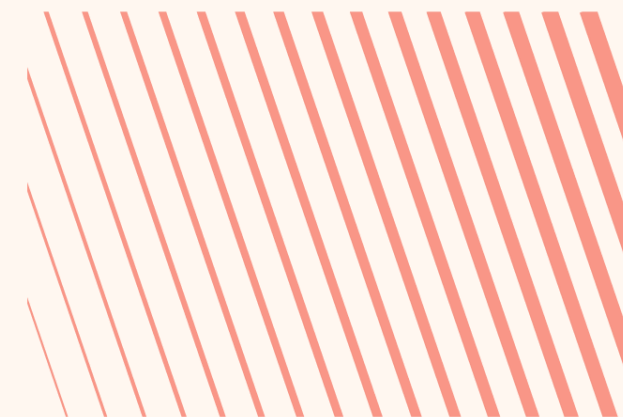

Thank you. Questions?



**PROGRAM SLIDE WITH
FURNITURE AS
EXAMPLE OF NEXT
STEPS FOR VERIFYING
PROGRAM FURTHER**